

Revo™

Adjustable Keyboards - Preconfigured Systems



Articulating keyboard system for mouse intensive applications

Combined with the Pinnacle 2™ arm, this is a popular solution for those who prefer to use the mouse positioned over the 10-key pad, or for users with limited reach. Generous mouse area minimizes reach and tilts independently from keyboard platform.



Quickly reposition mouse platform at keyboard level without tools



Pinnacle 2 Arm provides -15° to +10° tilt



Includes tilt indicator gauge for accurate tilt adjustment



Ergonomically designed knob provides easy tilt adjustment

Adjustability – Equipped with a Pinnacle 2 adjustable keyboard arm with:

- No-knob, no-lever height adjustment
- Dual adjustable lift-assist springs provide optimal balance and smooth movement

Adaptable – The Revo platform can comfortably adjust to the reach requirements of short as well as tall computer users. Mouse platform can be quickly switched from right to left side, enabling users to alternate mouse positions, and reduce muscle strain. The 1/4" Ultra-Thin™ phenolic platform minimizes the distance between the forearm and thigh, providing a greater range of ergonomic fit. The Revo keyboard platform also features the Optimizer™ with built-in document holder and cord manager.

Functional – The Revo System is adaptable to fit virtually all workstation shape and size requirements.

Durability – The Revo System meets or exceeds the ANSI/BIFMA standards for performance, durability, and cycle testing, and is backed by WorkRite's Limited Lifetime Warranty.

At WorkRite we believe that every body has a right to work comfortably and safely for maximum productivity. You can trust WorkRite - as 75% of Fortune 100 companies have - to create innovative solutions that flex to the diverse range of user needs, preferences and settings at work today.

Revo

Adjustable Keyboards - Preconfigured Systems

Articulating keyboard system for mouse intensive applications

Combined with the Pinnacle 2 arm this is a popular solution for those who prefer to position their mouse over the 10-key pad. Generous mouse area minimizes reach. Mouse platform tilts independently from keyboard platform.

	Foam	Track Length	Weight	Model #
Keyboard Platform features:	Jel	22"	20	2227-22J
	Standard	22"	20	2227-22
	Jel	17"	18	2227-17J
	Standard	17"	18	2227-17

Keyboard Platform features:

- Model UB-2100FT-25 platform
- The Ultra-Thin™ keyboard platform is a light weight, durable and easy to clean surface
- Over 70 square inches of mousing area
- 360° swivel allows mouse platform to position over key pad, or at keyboard level in a Mouse-Forward™ position
- JelRite™ foam optional in palm support
- Converts from right to left-handed mousing with no tools required
- Mouse platform tilts independently from keyboard platform
- Includes the Optimizer with built-in document holder and integrated cord management
- Removable LeatheRite™ palm support

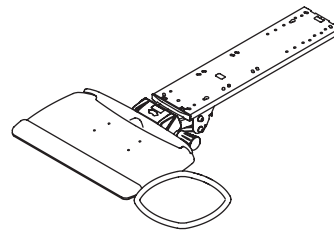

Keyboard Arm features:

- Model 3170 Pinnacle 2 arm in 17" or 22" low-profile ball bearing track
- Tilt range -15° to +10°
- Tilt indicator gauge for accurate tilt angle measurement
- Soft touch ergonomic knob for easy tilt control adjustment
- Dual counterbalance lift-assist springs
- Height range - flush to 6" below surface
- 360° swivel-easy positioning and storage
- Fully independent height and angle controls
- Low profile progressive ball bearing track
- No-knob, no-lever Lift-N-Lock™
- Maximum knee clearance
- Optional no positive tilt kit restricts tilt from 0° to -15°, ordered separately

Dimensions

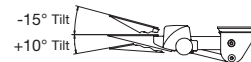
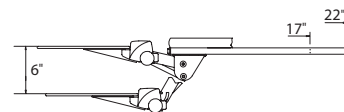
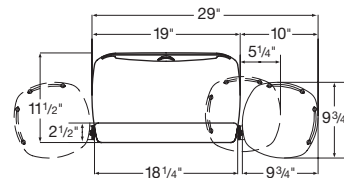

Available in black only
 Limited lifetime warranty
 Meets and exceeds ANSI/BIFMA standards

Desk Compatibility

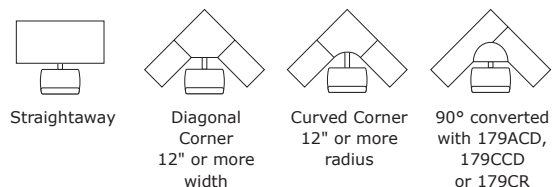

The following are federally registered trademarks of WorkRite Ergonomics: Stylized I[®], and WorkRite Ergonomics[®]. The following are trademarks of WorkRite Ergonomics: JelRite™, LeatheRite™, Lift-n-Lock™, Mouse-Forward™, Optimizer™, Pinnacle 2™, Quick Ship Logo™, Revo™.